

RFR 6000 Rack Frame for greenMachine

For optimum placement within an equipment room, greenMachine hardware can be mounted in a 19" rack enclosure, the RFR6000 1RU rack frame option.

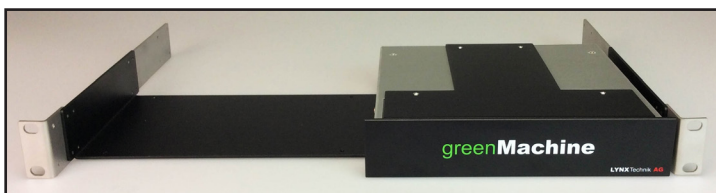

Each rack frame chassis (model: RFR 6000) can accommodate either **1** or **2** pieces of greenMachine hardware and two power supplies (model: RPS 6120).

1 ONE greenMachine WITH ONE OR TWO POWER SUPPLIES



2 TWO greenMachines WITH ONE OR TWO POWER SUPPLIES



UNPACKING THE RFR 6000 RACK FRAME

We have included everything that is required for assembling the one or two greenMachine setup.

WHAT'S IN THE BOX?

- ✓ 1x 1RU rack frame mounting tray (RFR 6000)
- ✓ 2x 19" mounting brackets (RML 6000)
- ✓ 1x power bridge (RPB 6000)
- ✓ 24x 3mm countersunk screws
- ✓ 4x 2.5mm countersunk screws
- ✓ 1x Quick Reference Guide
- ✓ 1x Warranty Card
- ✓ 1x Phillips screwdriver

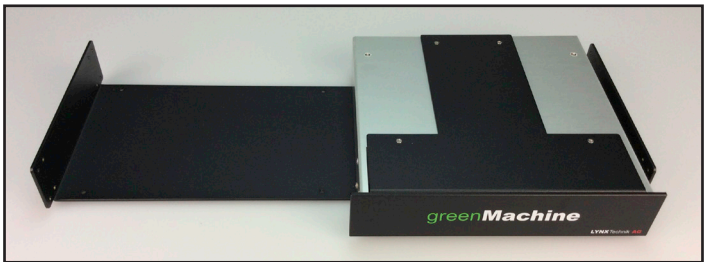

1RU rack frame mounting tray
(RFR 6000)

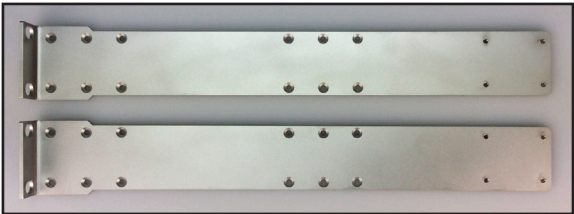

19" mounting brackets
(RML 6000)



Power Bridge
(RPB 6000)

ASSEMBLING YOUR RACK FRAME CHASSIS:

1 ONE greenMachine WITH ONE OR TWO POWER SUPPLIES

Step 1: Assemble the 2x 19" mounting brackets (see page 6). **MB**

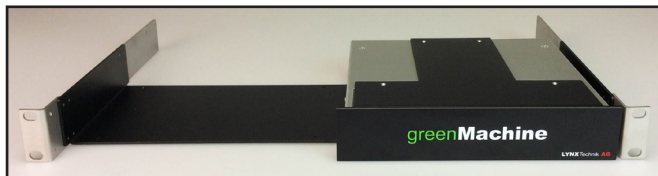

Step 2: Turn the greenMachine hardware upside down and remove the 4x feet from the bottom. Set the four screws aside for later use.

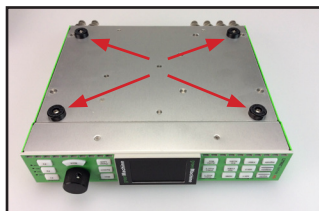

Step 3: Place the rack frame mounting tray over the bottom of the hardware and align the holes in the mounting tray with the holes where the feet were. Use the 4x 3 mm countersunk screws to attach the mounting tray to the hardware.

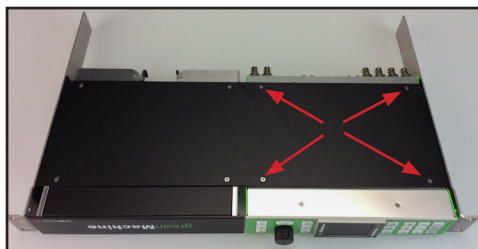

Note: DO NOT use the screws that were used to attach the feet.

Step 4: Turn the greenMachine hardware in rack frame the correct way up. Insert the power supplies (see page 7). **PS**



2 TWO greenMachines WITH ONE OR TWO POWER SUPPLIES

Step 1: Assemble the 2x 19" mounting brackets (see page 6). MB

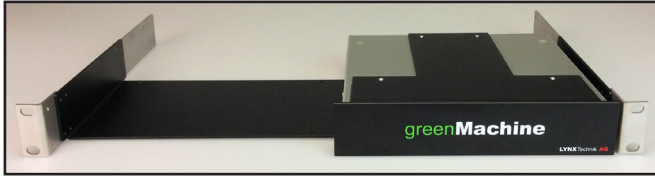

Step 2: Turn the rack frame upside down and remove the power supply container by unscrewing the 4x countersunk screws.

Set the power supply container and screws to the side. These screws will be used to attach the greenMachine to the mounting tray.



Step 3: Turn both the greenMachine modules upside down and place them next to each other. Remove the 4x feet from the bottom of each of greenMachine. Set the eight screws together with the feet aside for possible later use.

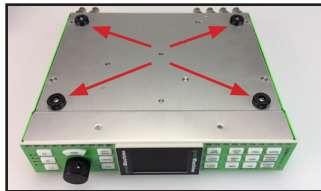
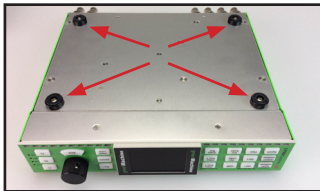

Step 4: Place the rack frame mounting tray over both greenMachines and align the holes in the mounting tray with the holes where the feet were. Use the 4x 3mm countersunk screws to attach the mounting tray to the hardware.

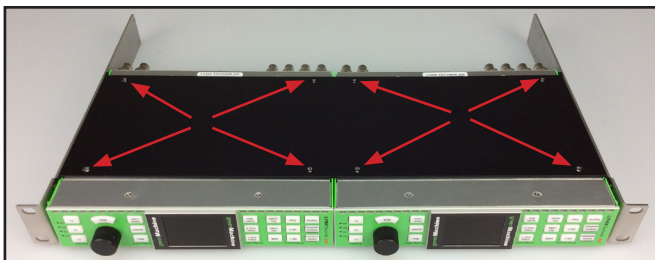

Step 5: Take the power supply container and remove the four screws on the top.

Note: These 4x countersunk screws are smaller than the other screws and should not be used for any other assembly in the rack frame. Set these four screws aside for possible later use.

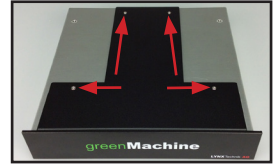

Step 6: Remove the 4x screws on both sides of the power supply container.

Note: Set these eight screws aside as they will later be required to attach the power supply mounts to the mounting brackets.

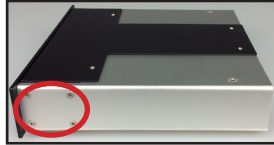

Step 7: Remove the power supply mounts.

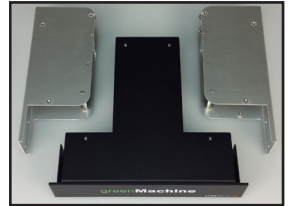

Step 8: You are now ready to place the power supply mounts to the 19" mounting brackets. Place the two power supply mounts on the inside at the end of each of the 19" mounting brackets.

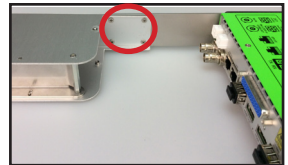
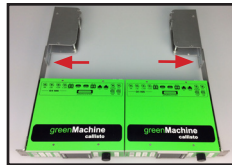
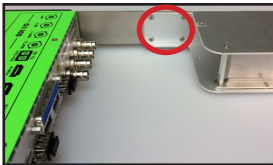

Attach the power supply mounts to the rack frame mounting brackets with the screws you removed from the sides of the power supply container.

Step 9: Insert the power supplies (see page 7). 





HOW TO ASSEMBLE THE 19" MOUNTING BRACKETS AND ADJUST RACK POSITION

Step 1: Choose your desired rack position.



Step 2: Use the 3mm screws to assemble the mounting brackets.
Use 4x screws for each mounting bracket.

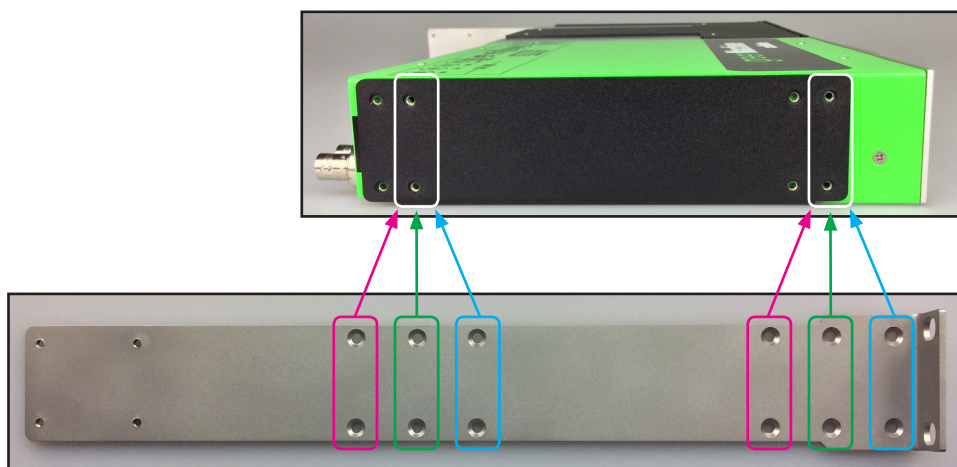



HOW TO INSERT THE RPS 6120 POWER SUPPLIES INTO THE RACK FRAME

Step 1: Unlock and slide over the power supply support clip.

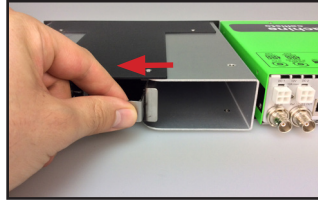
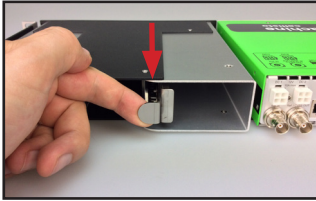

Step 2: Insert the power supply that came with your greenMachine into the power supply mount. The power cable needs to be next to the power supply as shown below.

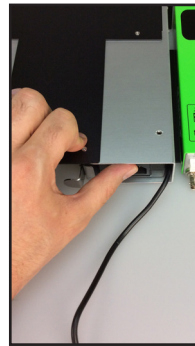
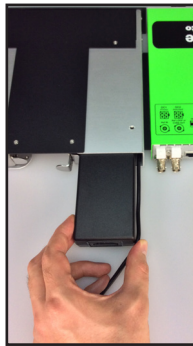
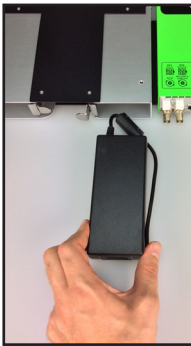

Note: The power supply should slide into the power supply mount without resistance. If not, then remove the power supply and make sure the power cord is positioned correctly.

Do not force the power supply into the mount.

Step 3: Slide over and push the power supply support clip forward to lock the power supply.



Step 4: Repeat this procedure for the second power supply if applicable.



HOW TO USE THE RPB 6000 POWER BRIDGE FOR POWER REDUNDANCY

For full power redundancy with two greenMachines mounted in the rack frame, use the RPB 6000 Power Bridge cable.

Step 1: Connect a power supply to the DC 1 connector of each greenMachine.

Step 2: Connect the DC 2 connectors of both greenMachines with the power bridge cable.



With this setup each power supply will continue to power both greenMachines even if one of the power supplies should fail.

SPECIFICATIONS

	SINGLE MODULE SETUP	TWO MODULE SETUP
DEPTH	29.7cm (11.69")	44.7cm (17.59")
WIDTH	Standard 19" Rack Mount	
HEIGHT	1RU	
MODEL #	RFR 6000	
EAN #	4250479324466	
INCLUDES	1x RFR 6000 rack frame mounting tray, 2x RML6000 mounting brackets, 1x RPB 6000 power bridge, 24x 3mm Screws, 4x 2.5mm Screws, 1x Phillips screwdriver	